

# Installation Manual

## FES20 Series ELECTRIC STRIKE

### PRODUCT

- FES20 Non Monitored Strike (not SCEC approved)
- FES20M see new separate Manual for FES20M
- FES20M-L2 Monitored Strike Lipless (SCEC approved)
- FES20M-R Monitored Strike with additional integrated Reed Door Position Switch (DPS) (not SCEC approved)

### ACCESSORIES

- FES20-EL 15
- FES20-EL 25
- FES20-EL 50
- FES20-EL 75

### MORTICE LOCK FACEPLATES EQUIPPED WITH A SET OF MONITORING MAGNETS

- Australian Lock Company FES20MR-AUS
- DORMA FES20MR-DOR
- KABA FES20MR-KAB
- Legge FES20MR-LEG
- Lockwood FES20MR-LOC
- Nova FES20MR-NOV
- Other mortice lock types or cylindrical locks on request

### WIRING

When installation of the strike and the mortice lock face plate is completed, connect the wiring according to list below:

<b>Power Input</b>	Multi Voltage 11-30VDC	12 VDC – current 220 mA	24 VDC – current 110 mA
<b>Wire output</b>	Red (+)	Black (-)	
<b>LSS (Lock Status Sensor)</b>	Black (Common)	Yellow (NO-PTO); (NC-PTL)	Green (NC- PTO); (NO-PTL)
<b>DSS (Door Status Sensor)</b>	Black (Common)	Blue (NO)	Orange (NC)
<b>ATS (Anti – tamper Sensor)</b>	Black (Common)	Red (NO)	White (NC)
<b>Sensor Output</b>	LSS Sensor Output 3 A, 125 VAC; 2 A, 30 VDC.	DSS Sensor Output 3 A, 125 VAC; 2 A, 30 VDC.	Anti-tamper Sensor Output 5 A, 125 VAC; 3 A, 250 VAC.
<b>DPS (Door Position Status)</b>	Grey	Grey	Normally Open Contacts Door Position Switch 0.5A, 30VDC

The FES20M-R monitored Electric Strike is equipped with an integrated Reed Door Position Switch (DPS). This function requires a special Mortice Lock Face Plate equipped with a set of magnets to operate in combination with the FES20M-R Electric Strike. FSH is providing a range of face plates from 6 manufacturers (see above). Face plates from other manufacturers on request.

### NOTE

- FES20 Series Electric Strike factory setting is Power to Lock (PTL) .
- The control circuit for the door strike is protected against reverse polarity connection. No additional diode protection required.

### PRODUCT DIMENSIONS

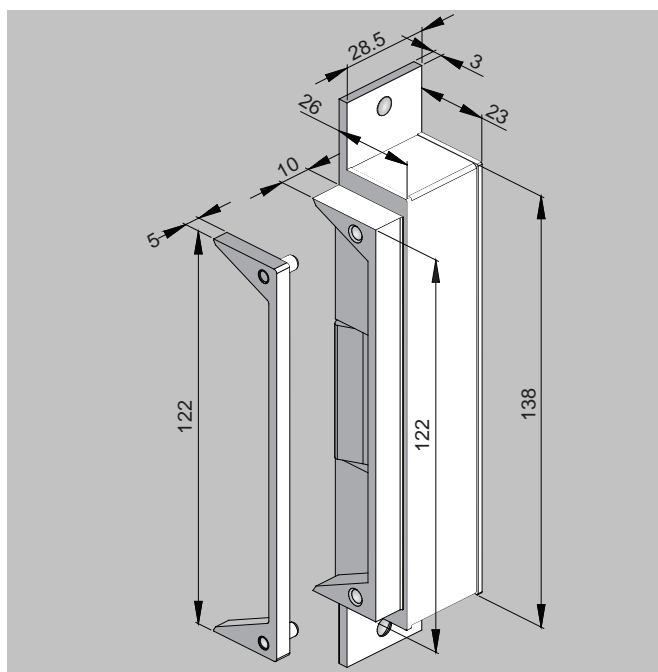
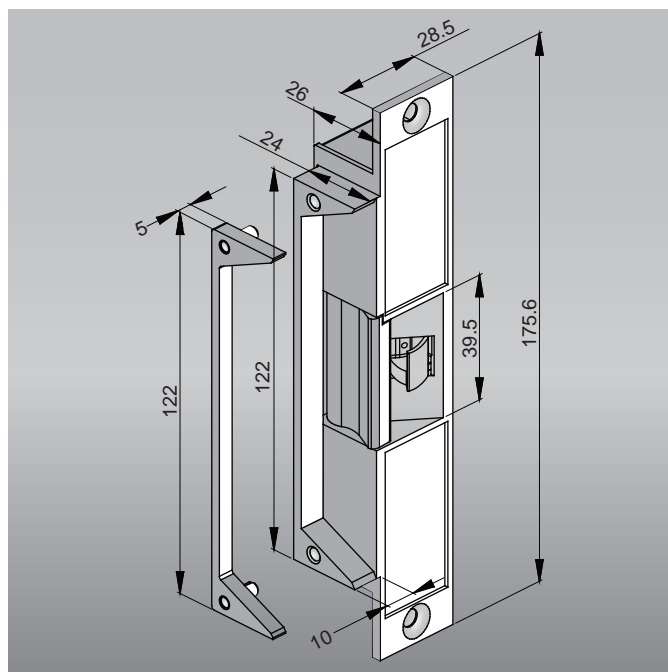

## INSTALLATION

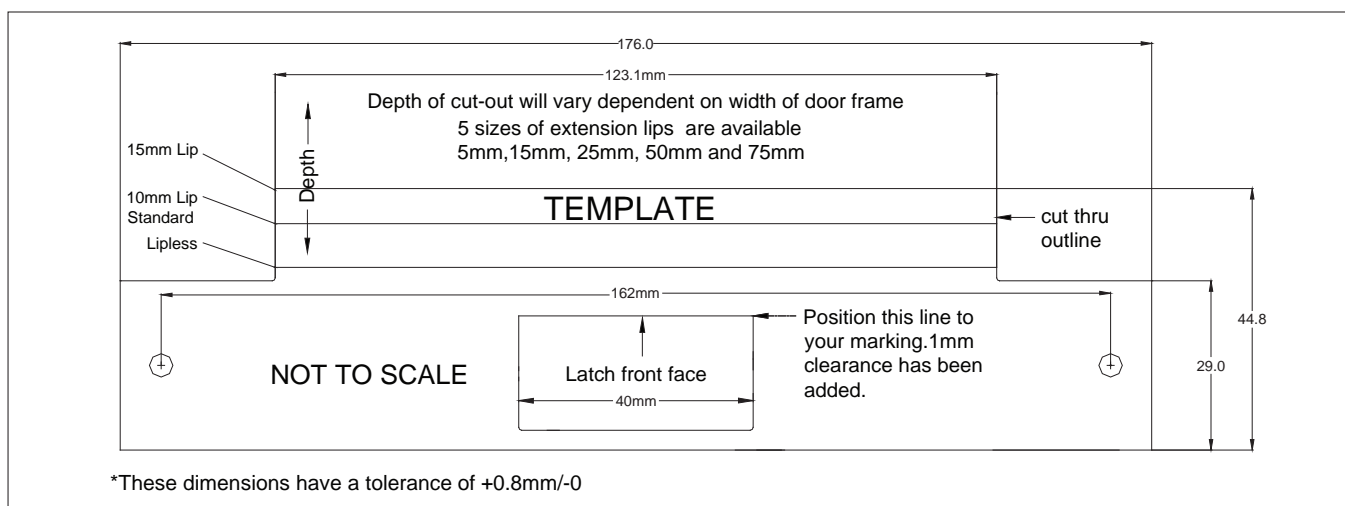
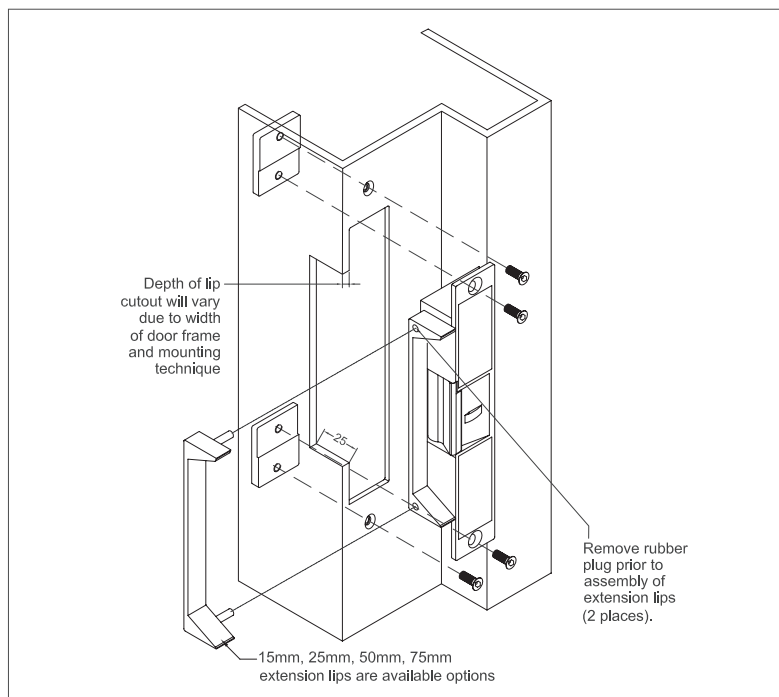

If frame is not prefabricated, use the enclosed stick-on template to prepare strike cut-out in frame. Install strike as described in diagram.

## POSITION OF DOOR LATCH

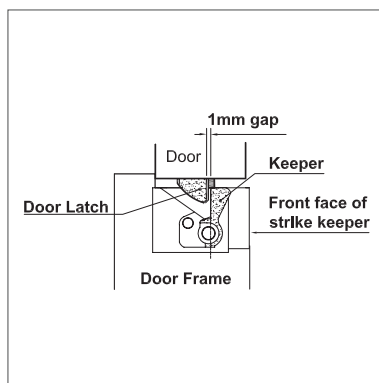
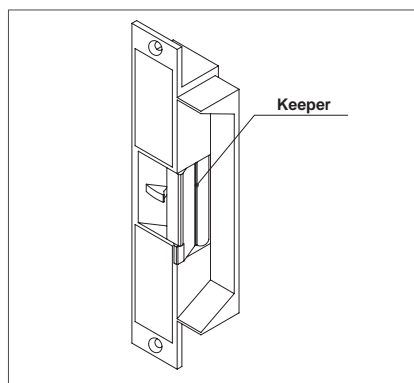

As drawn in the diagrams, there should be a 1mm gap between the door latch and the front face of the strike keeper, preventing the door from creating back pressure on the strike keeper when the door is closed.

## FIELD SELECTION

PROCEDURES TO CONVERT PTO (POWER TO OPEN) TO PTL (POWER TO LOCK)

1

Remove the rubber cap to expose the capstan wheel.



2

Slacken both of the capstan release screws two full revolutions, DO NOT REMOVE.



3

Remove the sticker from the cover end opening hole.



4

Insert the "tool pin" through the cover end opening hole and push down the solenoid. Hold it in position and at the same time insert the "tool" thru the cover plate opening hole and turn the capstan wheel in the direction of the keeper to the stop.

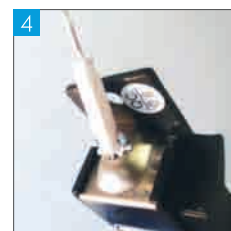

5

The strike is now in the Power to Lock mode.



6

Tighten the two capstan releasing screws replace the rubber cap.

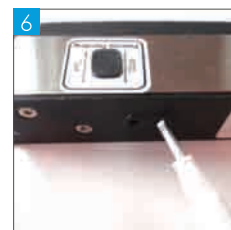

7

Replace the sticker after changing over locking function.



## FIELD SELECTION

PROCEDURES TO CONVERT PTL (POWER TO LOCK) TO PTO (POWER TO OPEN)

1

Remove the rubber cap to expose the capstan wheel.



2

Slacken both of the capstan release screws two full revolutions, DO NOT REMOVE.



3

Remove the sticker from the cover end opening hole.



4

Insert the "tool pin" through the cover end opening hole and push down the solenoid. Hold it in position and at the same time insert the "tool" thru the cover plate opening hole and turn the capstan wheel in the direction of the release screw to the stop.

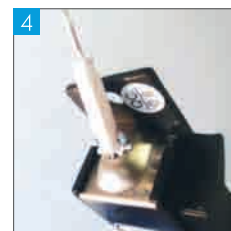

5

The strike is now in the Power to Open mode.



6

Tighten the two capstan releasing screws and replace the rubber cap.



7

Replace the sticker after changing over locking function.

